



# BOONE COUNTY INDIANA

OFFICIAL FARM PLAT BOOK AND DIRECTORY

Consult the convenient, helpful,  
Classified Directory in front of  
book to reach any type business  
in this area.

**PRICE**  
**\$7.50**

Published by  
County Plat and Directory Co., Inc.,  
LaPorte, Ind.

**COMPLIMENTS OF**  
**FARM BUREAU CO-OP**  
**&**  
**FARM BUREAU INSURANCE**  
**LEBANON, INDIANA**

# THE BOONE COUNTY STATE BANK

THE FRIENDLY BANK

SERVING THE FARMERS OF BOONE COUNTY FOR OVER 50 YEARS



Phone 243

LEBANON, IND.

**F. V. WHARRY  
AGENCY, INC.**

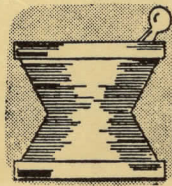

**MYERS**

**Pharmacy**

JAMESTOWN, IND.

\* WHERE INSURANCE IS NOT A SIDELINE

180 S. Main Street  
PHONE UP 3-3345

Prescriptions  
Veterinary Supplies  
Antibiotics -- Vaccines

Zionsville

Indiana

Geo. W. Myers, R. Ph.

Phone 676-7811

## CITIZENS STATE BANK



"CONTINUOUSLY FOR OVER 77 YEARS"



THE OLDEST BANK IN BOONE COUNTY

JAMESTOWN, INDIANA

AREA CODE - 317  
PHONE 676 - 5151



Est. 1896

# THE BOONE FARM MUTUAL

LEBANON, INDIANA  
124 E. WASHINGTON ST

## Insurance Company

PHONE 2342

\* COMPLETE FARM INSURANCE FACILITIES

OVER 65 YEARS OF SERVICE TO BOONE COUNTY RESIDENTS

### Walter J. Harpel Seed Company

PRODUCERS AND PROCESSORS OF  
CERTIFIED HYBRID SEED CORN  
AND OTHER FIELD SEEDS

World's Corn King in  
1947 and 1956

MODERN PLANT  
DARLINGTON

PHONE  
SW 4-4055

SHANNONDALE, IND.

### INDEX

Center Twp. East Part	9
Center Twp. West Part	11
Classified Directory	3
Clinton Township	13
Drainage Map	7
Eagle Township	14
Farmers Directory	24
Harrison Township	15
Highway Map	5
Jackson Township	16
Jefferson Township	17
Marion Township	18
Perry Township	19
Sugar Creek Township	20
Union Township	21
Washington Township	22
Worth Township	23

### Duff Farm Management Service

FARM MANAGEMENT FARM PLANNING  
LAND APPRAISALS SOIL ANALYSIS  
REAL ESTATE INVESTMENTS  
PHONE 434  
121 S LEBANON  
LEBANON, INDIANA

### EZRA MYERS



Free Estimates

House Insulation

Electrical Radiant Heat

Telephone 2021

924 N. LEBANON ST. LEBANON, IND.

### MARY BABER and ROSIE SELBY

Sterling Silver, China and Glassware Dept.

Jim Waggener  
Watch Repair

HALL & FRANK  
Established 1909

PHONE 215

LEBANON, IND.

There's a profitable difference in . . .



HYBRIDS . . . in BIN FILLER Grain Seeds, too!

PRODUCED BY

## MITCHELL FARMS

WINDFALL

INDIANA

# PETE RADER'S SALES & SERVICE

SEE YOUR . . .



**DEALER**

For Service, Parts,  
and Farm Equipment.

OUR REPAIR SHOP is experienced  
and stocked with parts for your  
*Cockshutt Machinery.*

USED MACHINERY OF ALL KINDS

PHONE 2308

813 W. PEARL

LEBANON

INDIANA

# CARL R. MORRIS

BOOKKEEPING & TAXES

INSURANCE

101 WEST MAIN STREET

THORNTOWN, INDIANA

OFFICE PHONE 436-7677

HOME 436-2671

EAST MAIN STREET

DARLINGTON, INDIANA

PHONE SW 4-4420

FOR ANY HOG, CATTLE OR SHEEP FEEDERS  
WRITE, CALL OR COME AND SEE



AREA CODE 317 PHONE 258-2667

## WILLIAM "BABE" RICHEY FARM DRAINAGE & GRAVEL

DRAINAGE & EXCAVATING  
CONTRACTOR

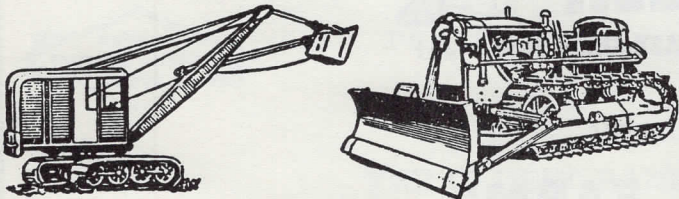

P.O. BOX 257

MICHIGANTOWN PH 249-2340 INDIANA

TILE DRAINS & BULLDOZING  
DREDGING

Gravel at Pit or Delivered

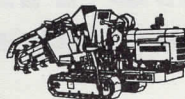

## CONES BROS.

MARTIN & CONES

A. CONES 436-7587

GRAVEL

C. CONES 436-7287

436-7745

THORNTOWN, IND.

# COUNTY WIDE CLASSIFIED DIRECTORY

These advertisers have made the free distribution of this book possible. They welcome your patronage.

	PAGE	CITY	PHONE		PAGE	CITY	PHONE
<b>ABSTRACTERS</b> Darnall & Sons	4	Lebanon	103	<b>HARDWARE</b> Ace Hardware	8	Lebanon	108
<b>ACCOUNTING &amp; TAXES</b> Carl R. Morris	2	Thorntown	436-2671	<b>INSULATION</b> Radiant Electric Heat	10	Lebanon	2189
<b>AUTOMOBILE DEALERS</b> Shelby Chevrolet	8	Lebanon	80	<b>INSURANCE</b> Boone Farm Mutual	1	Lebanon	2451
<b>AUTOMOBILE SUPPLIES</b> Midway Automotive Supplies	6	Sheridan	PL 8-4933	Farm Bureau Insurance	Cover	Lebanon	2455
<b>BANKS</b> Boone County State Bank	Cover	Lebanon	243	Harman Insurance Agency	6	Lebanon	484
Farmers State Bank	12	Zionsville		Houk & Son Insurance	13	Jamestown	676
Citizens State Bank	Cover	Jamestown	676-5151	The McCormick Agency	10	Lebanon	277
Farmers Bank	4	Kirklin		Carl R. Morris	2	Thorntown	436-2671
State Bank of Advance	4	Advance	329-5221	Nay Insurance & Real Estate	20	Thorntown	436-7222
<b>BUILDING SUPPLIES</b> Farm Bureau Co-op. Assn. Inc.	Cover	Lebanon	2080	Quality Insurance, Inc.	Cover	Jamestown	676-5091
Stahl-Baker Lumber Co.	Cover	Whitestown	769-3228	F V Wharry Insurance	Cover	Zionsville	UP 3-3345
<b>CONCRETE PRODUCTS</b> Lebanon Concrete Products Co.	12	Lebanon	441	<b>JEWELRY</b> Hall & Frank	1	Lebanon	215
<b>CONTRACTORS (Drainage)</b> Cones Bros.	2	Thorntown	436-7587	<b>LOANS (Farm)</b> Federal Land Bank	10	Lebanon	2342
<b>CONTRACTORS (Electrical)</b> Ezra Myers	1	Lebanon	2021	<b>LUMBER</b> Stahl-Baker Lumber Co.	Cover	Whitestown	769-3228
<b>CONTRACTORS (Excavating)</b> James Metzger Excavating	11	Lebanon	2775	Stahl Bros. Lumber Co., Inc.	Cover	Sheridan	PL 8-4216
William "Babe" Richey	2	Michigantown	249-2340	<b>MONUMENTS</b> Lovell Monuments	8	Lebanon	161
<b>CONTRACTORS (General)</b> Harry Hawkins	10	Lebanon	1888	<b>MOVING</b> Boone County Transfer	8	Lebanon	130
<b>DEPARTMENT STORES</b> Sears Catalog Sales Office	8	Lebanon	2468	<b>PAINT &amp; HARDWARE</b> Boone County Hardware	12	Lebanon	125
<b>DRUGS</b> Myers Pharmacy	Cover	Jamestown	676-7811	<b>PETROLEUM PRODUCTS</b> Farm Bureau Co-op Assn., Inc.	Cover	Lebanon	2080
<b>FARM EQUIPMENTS</b> Pete Rader Sales & Service	2	Lebanon	2308	C. S. Nelson	10	Lebanon	622-W
Roberts Farm Equipment Co., Inc.	12	Lebanon	2313	Titus Petroleum Co., Inc.	8	Lebanon	1139
<b>FARM MANAGEMENT</b> Duff Farm Management Service	1	Lebanon	434	Standard Service & Garage	6	Advance	329
<b>FEEDERS</b> WLC Co.	2	Sedalia	258-2667	<b>REAL ESTATE</b> The McCormick Agency	10	Lebanon	277
<b>FLORISTS</b> Paul O. Tauer Florist	12	Lebanon	367-W	Nay Insurance & Real Estate	20	Thorntown	436
<b>FOOD MARKETS</b> McCain's I.G.A. Foodliner	10	Lebanon	548	United Farm Agency (Joseph Sommers)	4	Kirklin	279-8247
<b>GAS (Bottled)</b> Kizar & Sons	6	Colfax	170	<b>SAND &amp; GRAVEL</b> Dick Gravel Co.	4	Thorntown	436-7665
<b>GRAIN</b> Boone Grain & Feed Co.	9	Lebanon	74	<b>SAVING &amp; LOANS</b> Union Federal Savings & Loan Assn.	3	Lebanon	111
Stahl Bros. Lumber Co.	Cover	Sheridan	PL 8-4216	<b>SEEDS</b> Walter Harpel Seed Company	1	Shannondale	SW 4-4055
<b>GRAIN ELEVATORS</b> Durham & Shirley, Inc.	12	Lebanon	2301	Mitchell Farms	1	Tipton	LY 5-2415
Farm Bureau Co-op Assn.	Cover	Lebanon	2080	<b>SEPTIC TANK SERVICE</b> Smith Sanitary Service	Cover	Sheridan	PL 8-4395
<b>GRAVEL</b> Cones Bros.	2	Thorntown	436-7587	<b>TIRES</b> Farm Bureau Co-op Assn.	Cover	Lebanon	2080
				<b>TRUCKS</b> Roberts Farm Equipment Co., Inc.	12	Lebanon	2313
				<b>VETERINARY SUPPLIES</b> Hine Pharmacy	Cover	Whitestown	769-3247
				Myers Pharmacy	Cover	Jamestown	676-7811
				<b>WEARING APPAREL</b> The Boy's Shop	10	Lebanon	307-W

## INSURED SAVINGS

Dividends  
Compounded  
Semi-annually

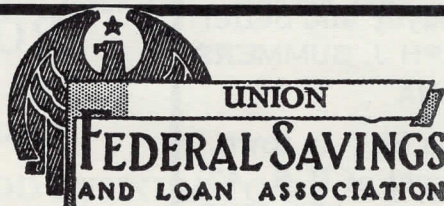

102 North Lebanon St.

Lebanon, Ind.

## HOME LOANS

Remodel—  
Refinance—  
Buy—  
Build



Est. 1896

# THE BOONE FARM MUTUAL

LEBANON, INDIANA  
124 E. WASHINGTON ST

*Insurance Company*

PHONE 2342

\* COMPLETE FARM INSURANCE FACILITIES

OVER 65 YEARS OF SERVICE TO BOONE COUNTY RESIDENTS

# State Bank of Advance

COMPLETE BANKING



SERVICE — SAFETY

*63 Years of Continuous Service*

Advance

Phone 329-5221

Indiana

# THE FARMERS BANK

Kirklín Branch

COMPLETE BANKING SERVICES SINCE 1876

OFFICES AT FRANKFORT — MICHIGANTOWN — MULBERRY

MEMBER OF FEDERAL DEPOSIT INSURANCE CORPORATION

ABSTRACTORS  
ESCROWS  
ABSTRACTS  
TITLE INSURANCE  
PHOTO PRINTERS

112 S. MERIDIAN  
LEBANON,  
INDIANA

## DARNALL AND SONS

CALL 103

Established Since 1875

MEMBERS  
AMERICAN AND INDIANA  
TITLE ASSOCIATION

## REAL ESTATE



The Sign of Service - To Buyer and Seller  
LOCAL REPRESENTATIVE - JOSEPH J. SUMMERS  
KIRKLIN, INDIANA

Office - 255 W. Jefferson St., in town,  
on state 38, 1 1/2 blocks west of U S. 421  
Res. - 105 N. Perry St. Ph. 279-8247

## DICK GRAVEL CO.

WASHED SAND & GRAVEL

ALL SIZES

ROAD MATERIAL

PLANT LOCATED ON  
FRANKFORT THORNTON ROAD  
ROUTE 1 BOX 132-A

THORNTOWN, INDIANA PHONE 436-7665

# COUNTY HIGHWAY MAP

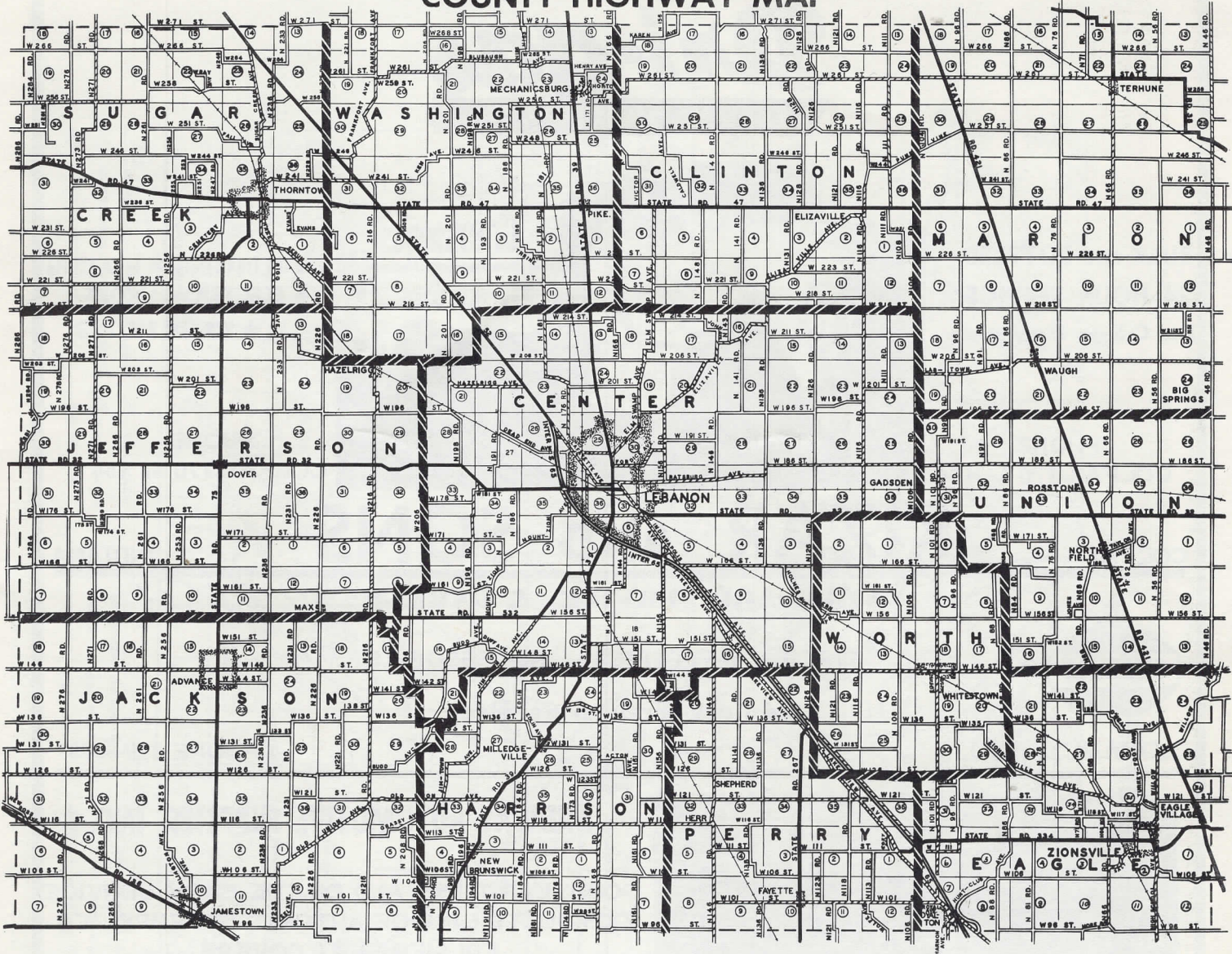

## COMPLIMENTS OF. "THE FARM BUREAU FAMILY"

BOONE COUNTY FARM BUREAU CO-OP ASSOCIATION - PHONE 2080  
 BOONE COUNTY FARM BUREAU CO-OP ELEVATOR - PHONE 2080 OR 2667  
 BOONE COUNTY FARM BUREAU, INC. - MEMBERSHIP - PHONE 8 OR 2455  
 FARM BUREAU INSURANCE - PHONE 2455



"IT'S GOOD BUSINESS TO BE IN FARM BUREAU"

# Dri-gas

THE ALL-PURPOSE FUEL

BULK and BOTTLED  
24 HOUR SERVICE  
Free Cylinder Installation

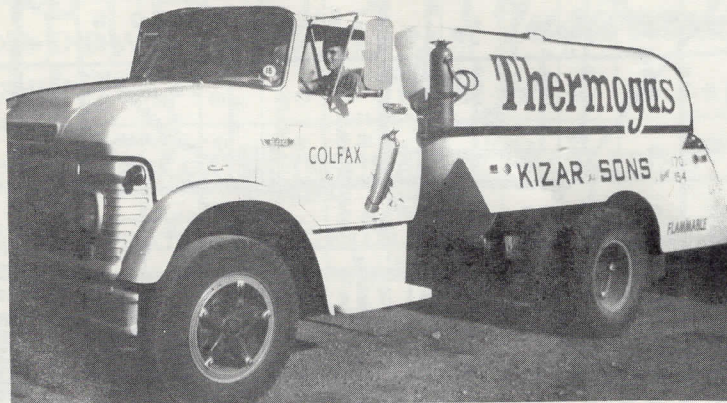

- PLUMBING • HEATING
- ELECTRICAL WORK
- ★ GRAIN DRYING

PHONE  
COLFAX 170 OR 154

PHONE  
COLFAX 170 OR 154

## KIZAR AND SONS

COLFAX

INDIANA

### STANDARD SERVICE & GARAGE



TIRES BATTERIES ACCESSORIES

24 Hour Wrecker Service

ADVANCE, IND.

PHONE 329-9091



### MIDWAY AUTOMOTIVE SUPPLIES, INC.

GOODYEAR TIRES AND ON THE FARM SERVICE  
COMPLETE LINE OF AUTOMOTIVE SUPPLIES  
FULMER SEAT COVERS  
DELCO - REMY - A.C. PRODUCTS  
AUTO LITE - CHAMPION

Phone PL 8-4933

102 E. 2nd

SHERIDAN, IND.

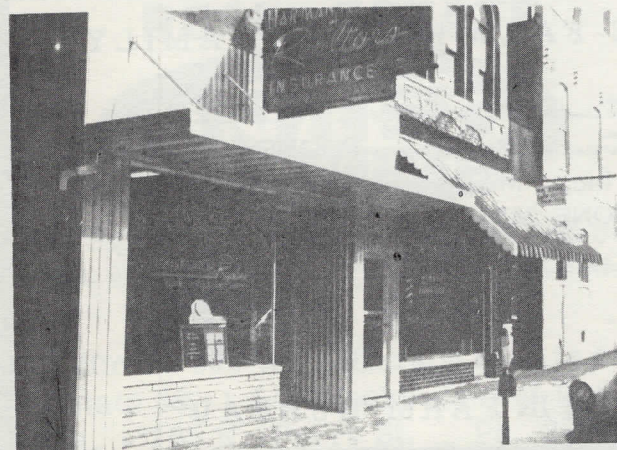

FOR THE BEST  
IN

REAL ESTATE - INSURANCE



WE SELL THE EARTH

AND

INSURE EVERYTHING ON IT!

HARMAN AGENCY, INC.

*Realtors*

TELEPHONE 484  
212 WEST MAIN STREET  
LEBANON, INDIANA

INSURANCE



# DRAINAGE MAP

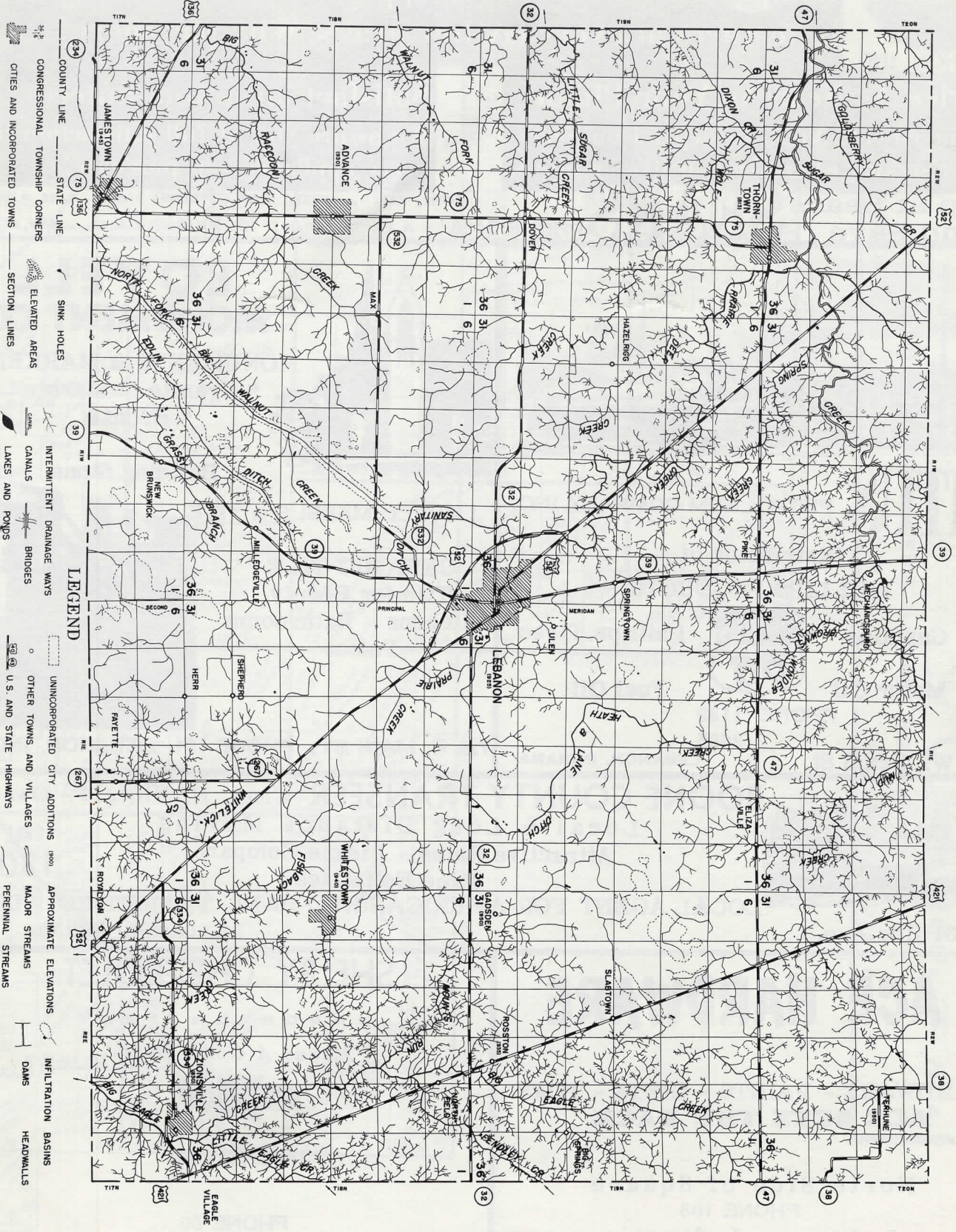

- LEGEND**
- COUNTY LINE
  - STATE LINE
  - CONGRESSIONAL TOWNSHIP CORNERS
  - CITIES AND INCORPORATED TOWNS
  - SECTION LINES
  - SINK HOLES
  - INTERMITTENT DRAINAGE WAYS
  - CANALS
  - BRIDGES
  - OTHER TOWNS AND VILLAGES
  - APPROXIMATE ELEVATIONS
  - MAJOR STREAMS
  - PERENNIAL STREAMS
  - INFILTRATION BASINS
  - DAMS
  - HEADWALLS



**Sears Does More... First Quality, Low Prices**  
**Compare! All Sears home appliances have extra built-in features at everyday low prices. Why pay more!**

LEBANON, IND

**Service As Near As Your Phone**  
 So convenient! You can depend on Sears expert service wherever you live or move.

**Satisfaction is Guaranteed**  
 We assure you of full satisfaction in every appliance you purchase!

Shop at Sears **SEARS**  
 and Save

PHONE 2468  
 MON., TUES., WED., SAT. THURS. 9 A.M. - 12 P.M.  
 9 A.M. TO 5 P.M. FRIDAY 9 A.M. - 9 P.M.



**TITUS** PETROLEUM COMPANY INC.

Distributor of  
**PHILLIPS PRODUCTS**  
 Gasoline Phillips Tires  
 Motor Oil Fuel Oil

PHONE 1139 2695  
 827 W. Pearl St. LEBANON, INDIANA

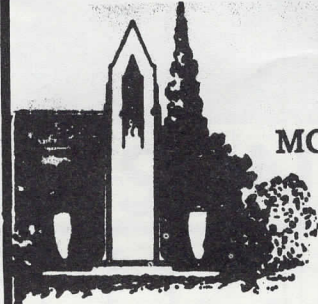

**LOVELL MONUMENT CO.**

MONUMENTS & MARKERS  
 \* Granite \* Marble  
 \* Bronze

Building Stone

LOVELL MARBLE & TILE

CERAMIC TILE  
 Tile for Beauty  
 Kitchens - Bathrooms  
 Patios

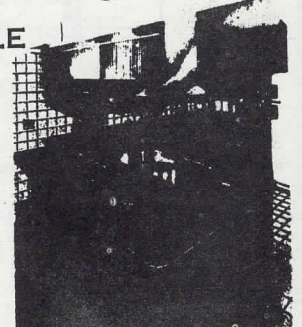

729 E. MAIN ST. PHONE 161 LEBANON, IND.



**BOONE COUNTY TRANSFER** Chas. N. Kincaid - Owner  
 Local & Long Distance Moving  
 Attractive Rates - Please Compare  
 Free Estimates  
 CALL 130

1131 Hoy Ave. LOCAL AGENT FOR AMERICAN RED BALL TRANSIT CO., INC. Lebanon, Indiana

**ACE HARDWARE**

HARDWARE - PAINTS - GIFTS - TOYS  
 "ACE SETS THE PACE"

North Side of Square  
 PHONE 108  
 Lebanon, Indiana

**SHELBY CHEVROLET**

INCORPORATED  
 "Means A Good Deal"



1902 TO 1964

PHONE 80

222 W. SOUTH ST. LEBANON, IND.

TOWNSHIP 18-19 RANGE N 1-E

EAST PART CENTER

Federal or State Highways  
County or Township Roads  
Railways

CLINTON TOWNSHIP

W 216 St.

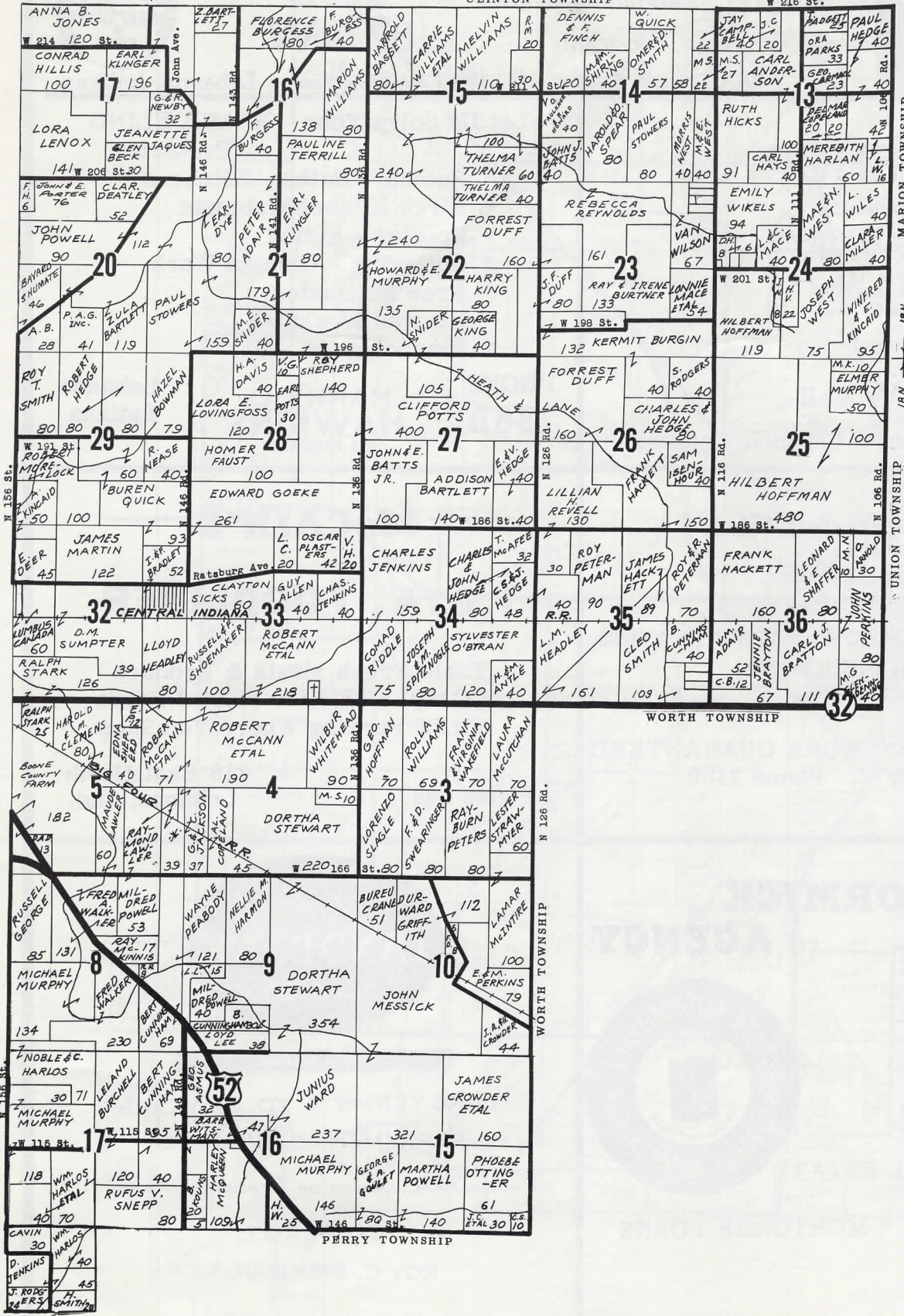

GRAIN  
FEED  
SEED  
COAL

**BOONE GRAIN AND SEED**

Custom Grinding & Mixing -- Seed Cleaning

*Company, Inc.*

310 S. Lebanon St.  
Phone 74  
LEBANON, INDIANA



**C. S. NELSON**

SUPPLIER OF SINCLAIR PRODUCTS

Fuel Oil - Gasoline - Oils  
Greases - Lubricants  
and Diesel Fuel

CALL  
**622-W**



1012 W. Main Rear Lebanon, Indiana

The  
**BOY'S SHOP**

GENTLEMEN 4 TO 20

COMPLETE LINE of BOYS WEAR

SUITS • COATS • SLACKS  
SHIRTS • SWEATERS  
OVERCOATS • JACKETS  
ACCESSORIES

Locally Owned

Call **307-W** Call

113 S. MERIDIAN Lebanon, Indiana

Let Us Solve Your **REMODELING**  
Problems

- \* Rooms - Baths - Kitchens
- \* Birch Kitchen Cabinets
- \* Roofing - Siding
- \* Guttering - Cement Work
- \* Free Estimates
- \* Insured Workmen
- \* Financing

PHONE  
**1888**

**HARRY D.  
HAWKINS**  
823 BARONNE

Lebanon  
Indiana

*Radiant Electric Heat*

Lebanon, Indiana

CABLE & BASEBOARD ELECTRIC HEATING  
BLOWN INSULATION

FREE ESTIMATES WORK GUARANTEED  
811 W. South St. Phone 2189

— **McCAIN'S** —

**I.G.A. FOODLINER**

Table Fresh Meats & Produce  
COMPLETE Line of Diet Foods  
FREE Parking Where You Shop

Phone 548

118 East North  
Lebanon, Ind.

**THE  
McCORMICK  
AGENCY**

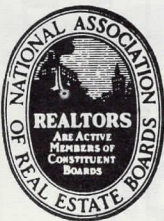

\* INSURANCE

\* REAL ESTATE

\* MORTGAGE LOANS



210 E. Main St.

Phone 277

LEBANON, INDIANA



FARM LOANS

LONG TERMS 5 TO 40 YEARS  
REPAYMENT PRIVILEGES  
NO APPLICATION OR APPRAISER FEES

CONTACT

ROY C. SIEKMAN, MGR

320 N. EAST ST. — PHONE 2342

LEBANON, INDIANA

TOWNSHIP 18-19 RANGE 1-W, 1-E

WEST PART CENTER

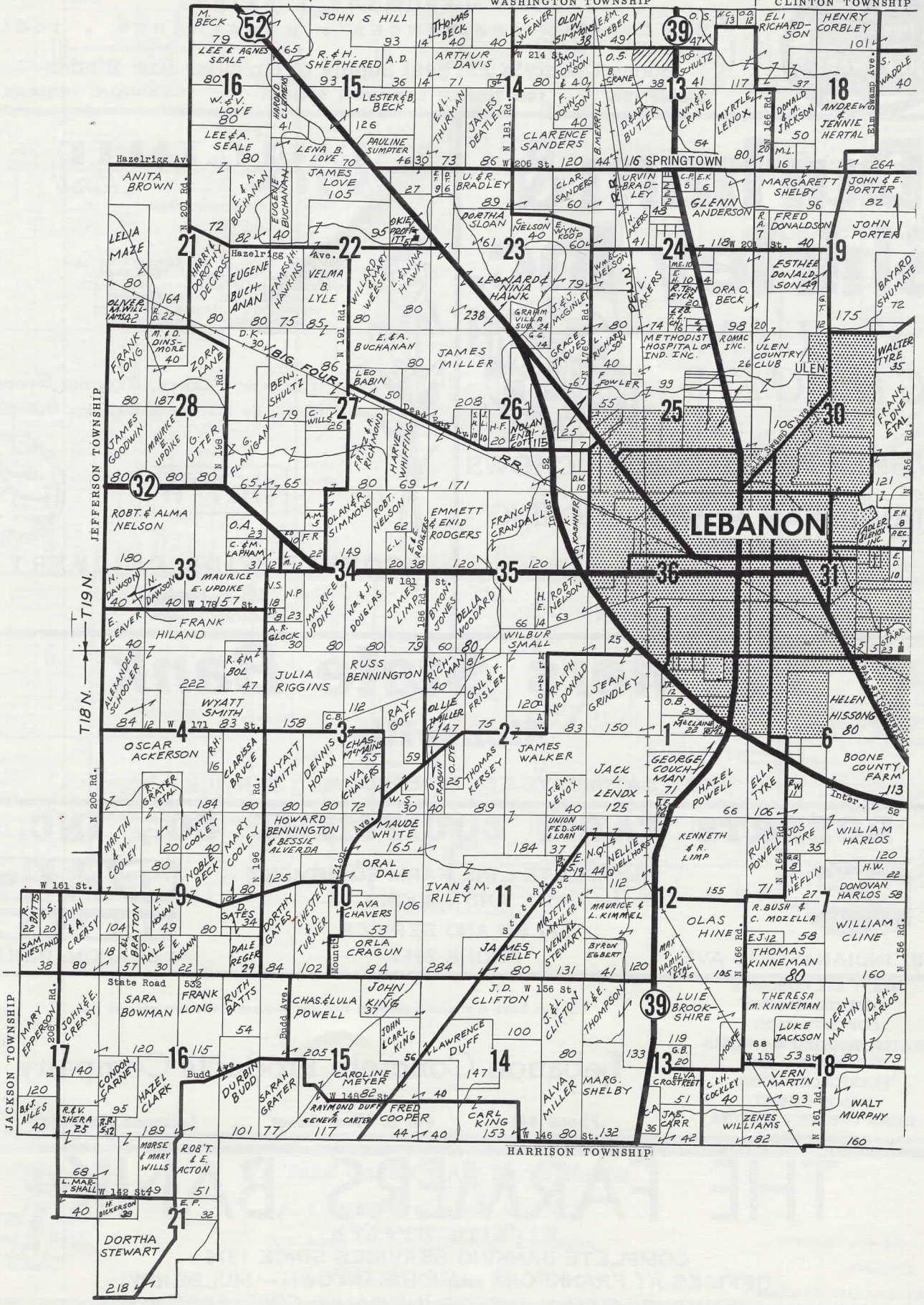
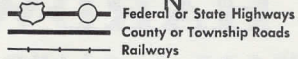

# BOONE COUNTY HARDWARE



HARDWARE • PAINTS  
ELECTRICAL APPLIANCES • HOUSEWARES • TOOLS

Boone County's Largest Supply of Circular Saw Blades  
PHONE 125 108 NORTH LEBANON STREET LEBANON, INDIANA

## Durham & Shirley, Inc.

HY-LINE  
CHICKS



SWISHER FEEDS PURINA CHOWS

JAMESWAY POWER CHORING  
PHONE 231  
407 East Noble Street  
Lebanon, Indiana

## PAULO. TAUER & SON Florists

ESTABLISHED 1900



PERSONAL SERVICES IN CONDUCTING and  
COORDINATING ALL OF YOUR FLORAL  
NEEDS FOR RECEPTIONS - PRIVATE PARTIES  
and BUSINESS ENTERTAINMENT  
WEDDINGS FUNERALS BIRTHDAYS  
ANNIVERSARIES THANK YOU

FOLIAGE PLANTS, BEDDING STOCK  
NURSERY STOCK & GARDEN SUPPLIES

CALL

367-W



COUNTY WIDE DELIVERY

501 E. Noble  
LEBANON, INDIANA

# Farmers State Bank

Zionsville

OPEN SATURDAYS FOR "PERSONAL" SERVICE

## ROBERTS FARM EQUIPMENT CO., INC.



COMPLETE LINE FARM EQUIPMENT  
AND TRUCKS  
SALES AND SERVICE  
PHONE 2313



1501 INDIANAPOLIS AVE.

LEBANON, INDIANA

READY MIX CONCRETE  
CONCRETE BLOCKS  
CONCRETE PAINT  
WATER PROOFING MATERIALS  
RE-ENFORCING ROD  
RE-ENFORCING MESH  
MASON CEMENT  
OTHER CONCRETE SUPPLIES  
AND PRODUCTS

If you have a concrete problem call our engineer. His services are free.

## Lebanon Concrete Products Company

Phone 441 416 S. West Street Lebanon, Indiana

# THE FARMERS BANK

Kirklin Branch

COMPLETE BANKING SERVICES SINCE 1876  
OFFICES AT FRANKFORT - MICHIGANTOWN - MULBERRY  
MEMBER OF FEDERAL DEPOSIT INSURANCE CORPORATION

19-20  
TOWNSHIP N RANGE I-E

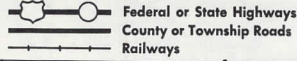

CLINTON

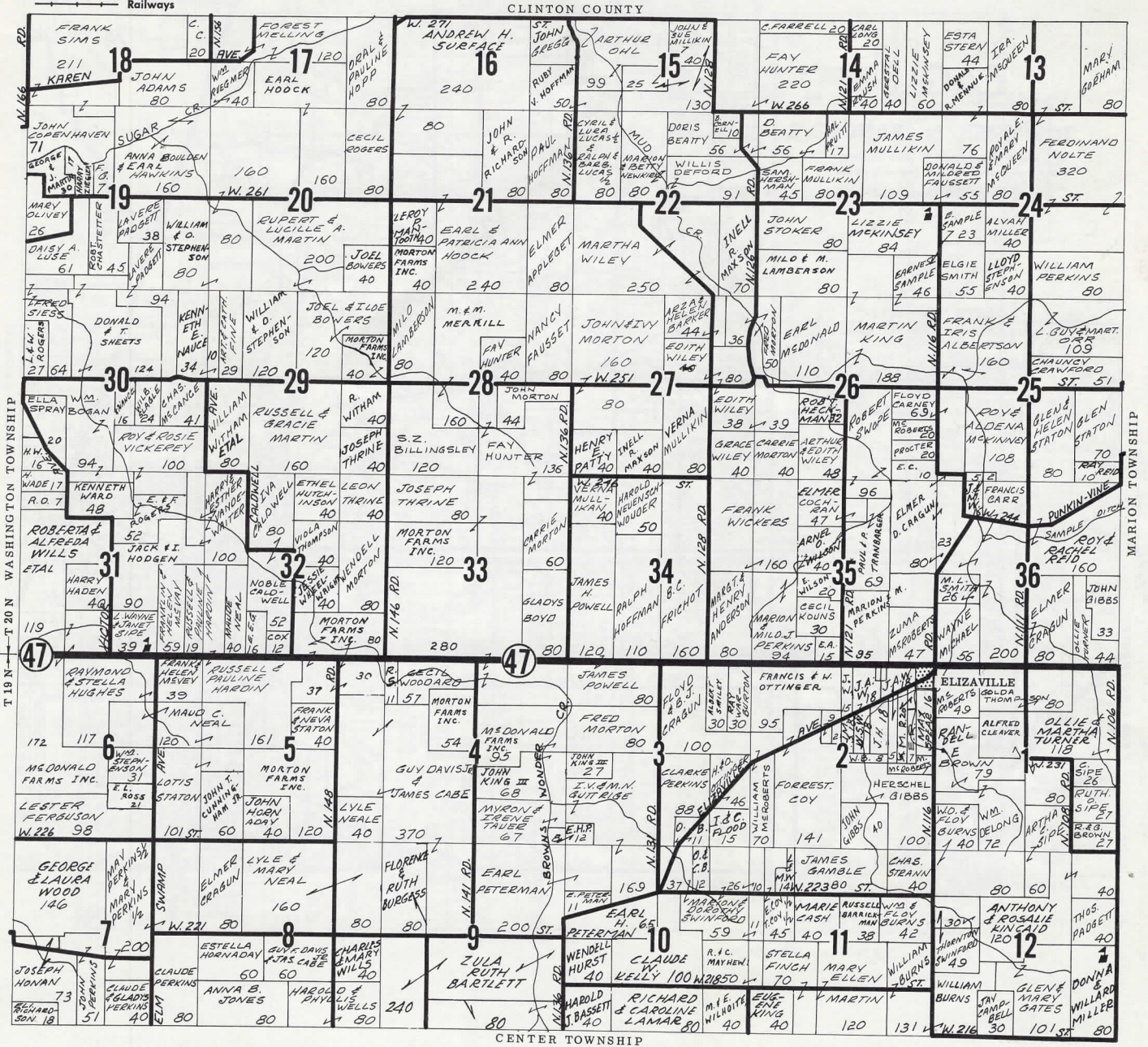

We Take Care Of All Farm Needs

**A. L. HOUK & SON AGENCY**  
Reliable Insurance Since 1900  
A. L. HOUK GEORGIA L. HOUK A. K. HOUK

PHONE 676-5881

676-7021



141 W. Main St.

JAMESTOWN, INDIANA



# EAGLE

17-18  
TOWNSHIP N RANGE 2-E

 Federal or State Highways  
 County or Township Roads  
 Railways

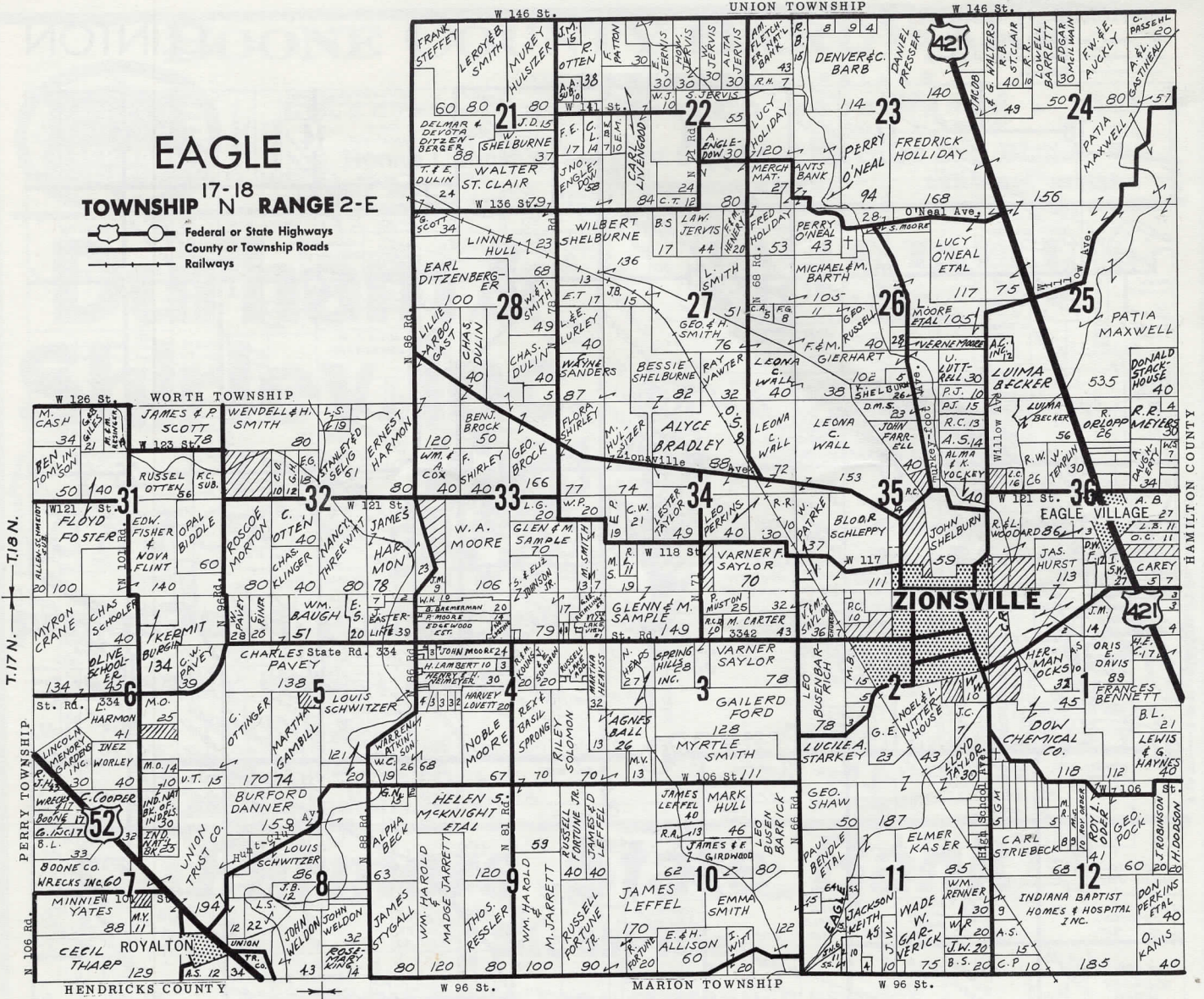

## INSURED SAVINGS

Dividends  
Compounded  
Semi-annually

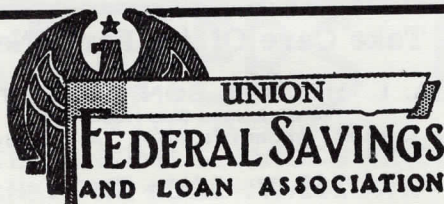

102 North Lebanon St.

Lebanon, Ind.

## HOME LOANS

Remodel—  
Refinance—  
Buy—  
Build



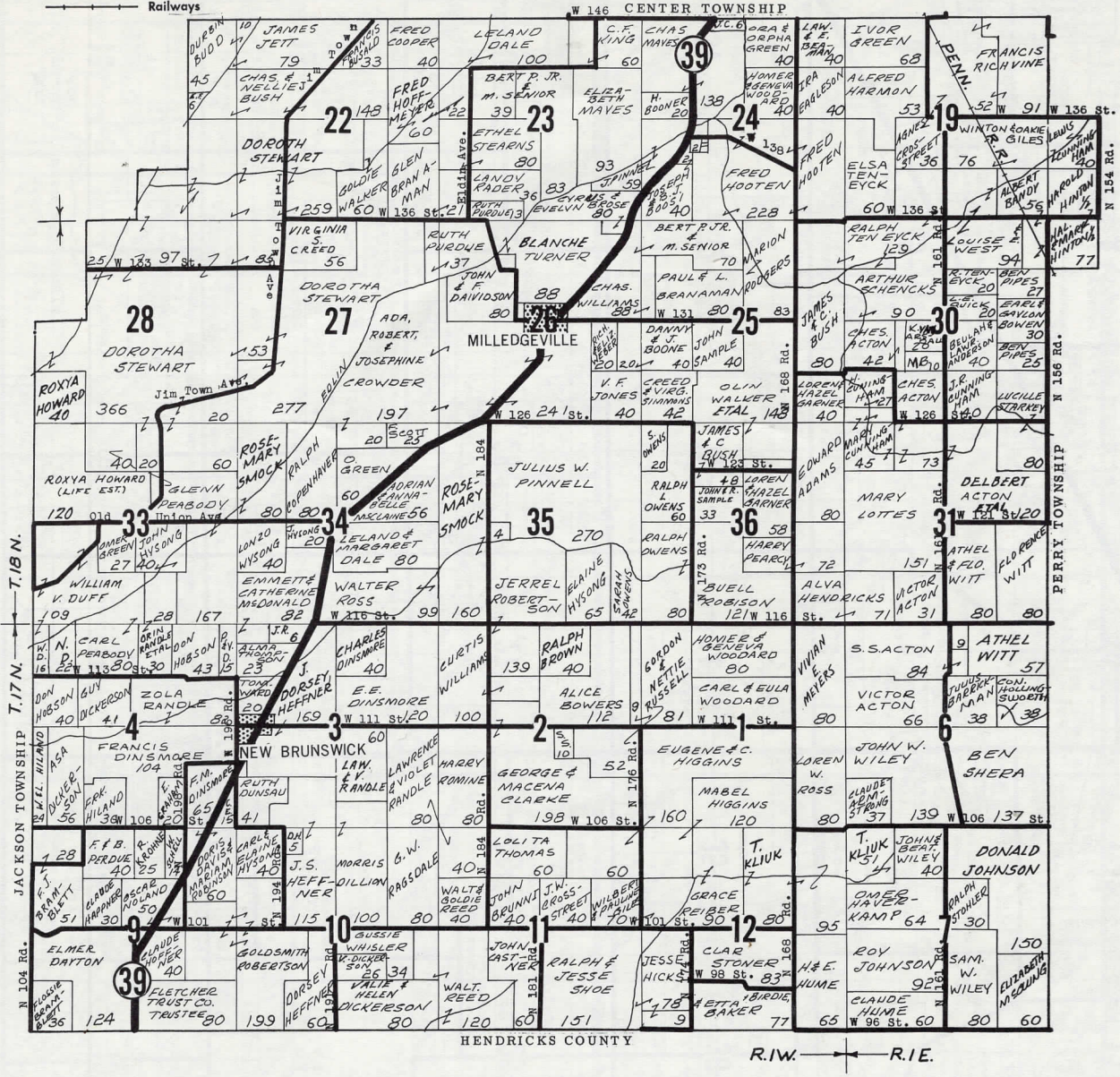
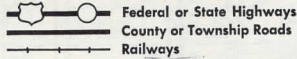

HENDRICKS COUNTY

R.1.W. ← R.1.E.

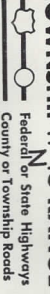

Railways

W 156 St.

JEFFERSON TOWNSHIP State Road 532

R 2 W - R 1 W

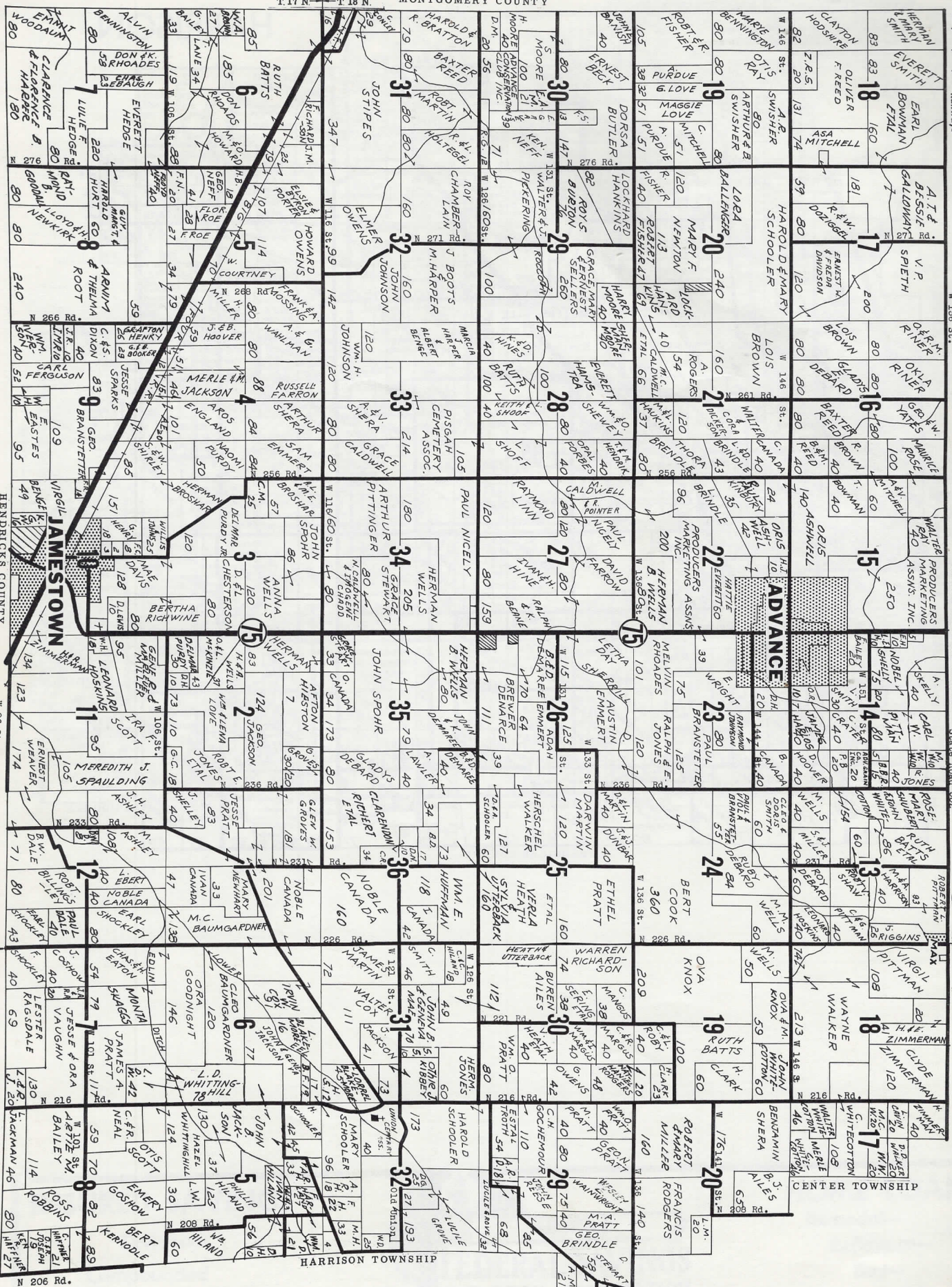

HENDRICKS COUNTY

W 96 St.

R 2 W - R 1 W

N 206 Rd.

W 216 St.

SUGAR CREEK TOWNSHIP

W 216 St.

# JEFFERSON

18-N-19 RANGE 1-2-W

Federal or State Highways  
County or Township Roads  
Railways

WASHINGTON TOWNSHIP

## HAZELRIGG

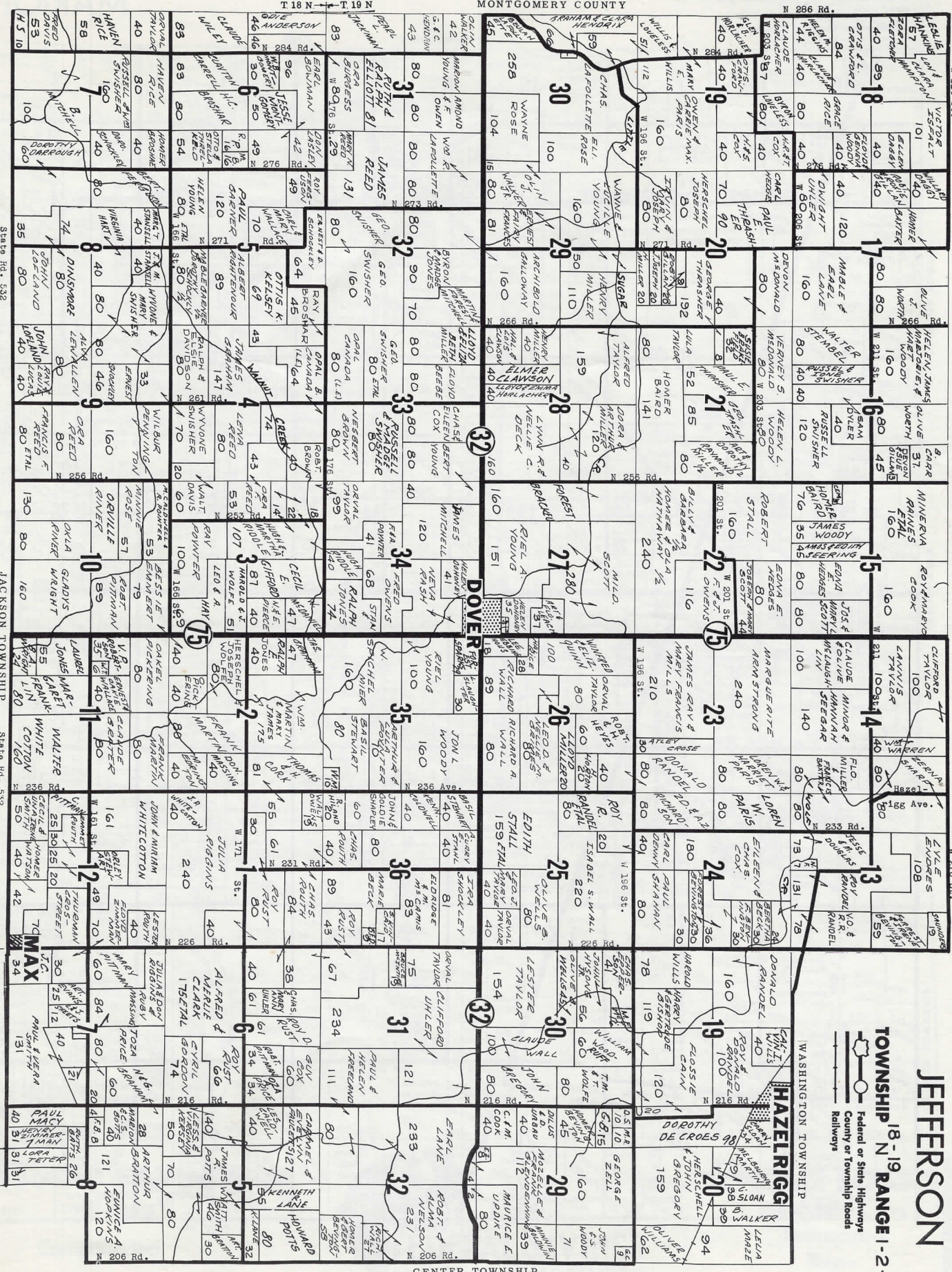

TOWNSHIP 19 - RANGE 2 - W

MARION

Federal or State Highways  
County or Township Roads  
Railways

CLINTON COUNTY

38

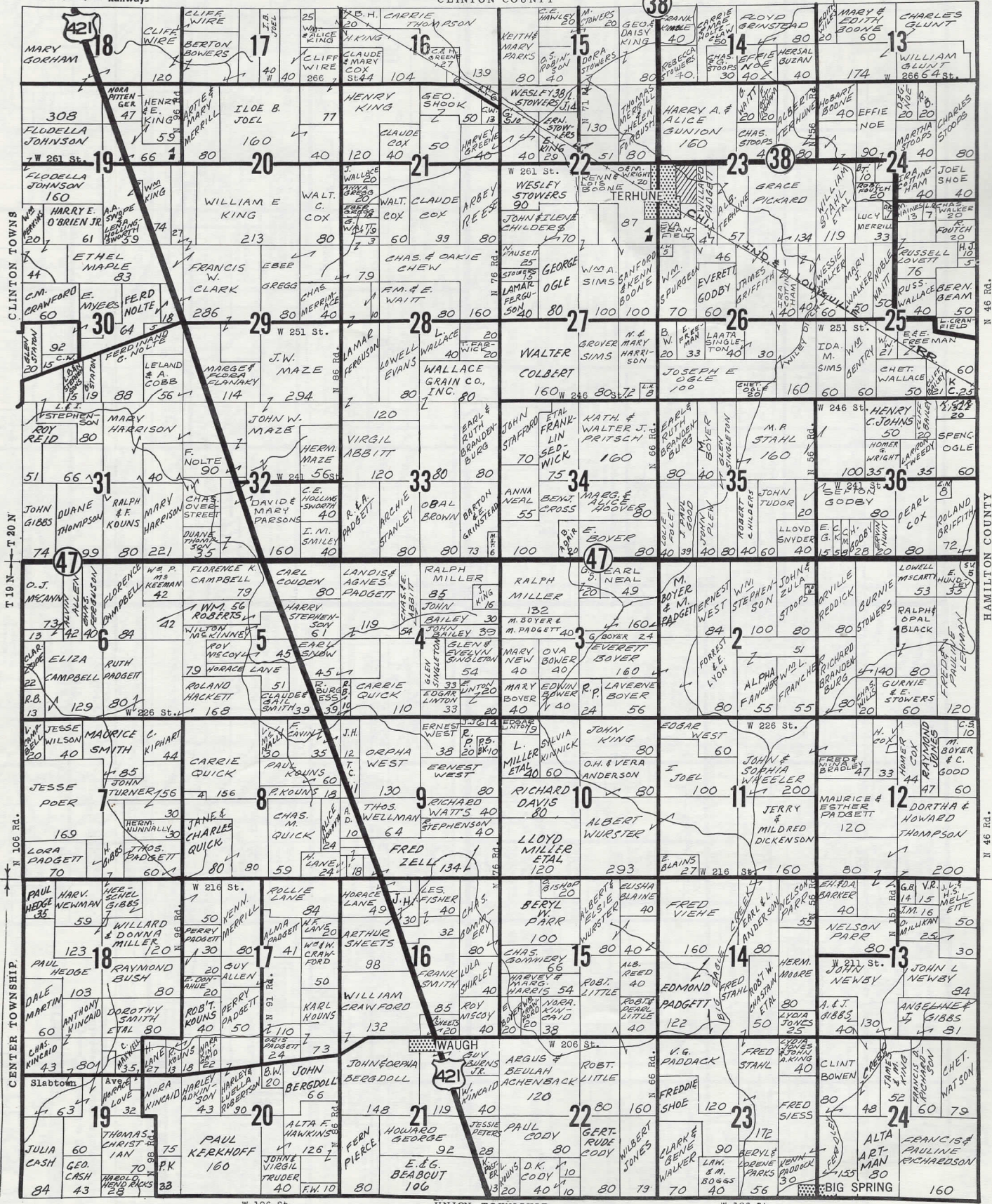

W 196 St.

UNION TOWNSHIP

W 196 St.

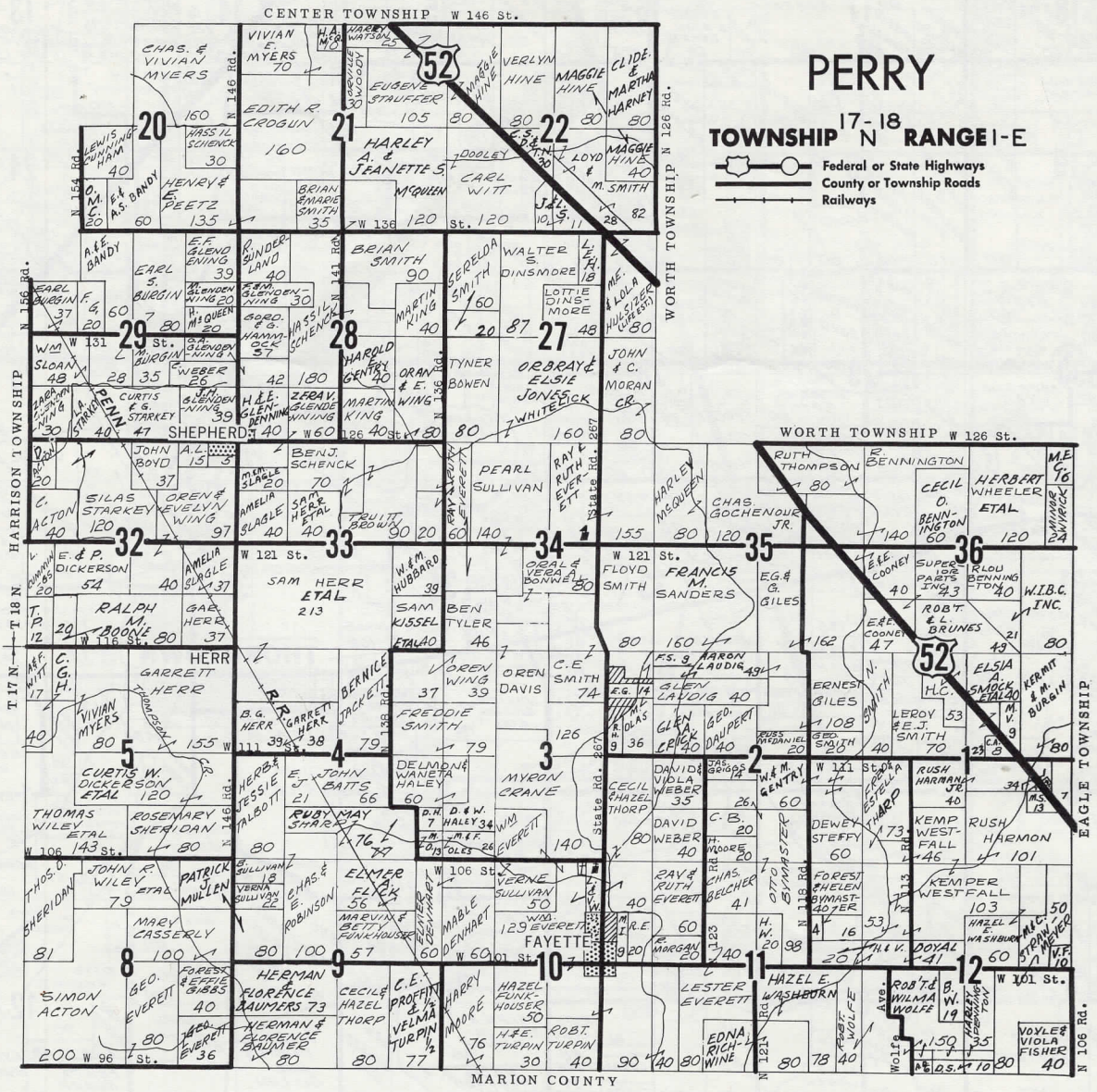

**INSURED SAVINGS**

Dividends  
Compounded  
Semi-annually

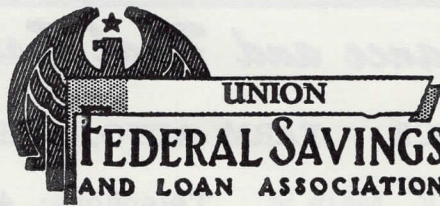

**HOME LOANS**

Remodel—  
Refinance—  
Buy—  
Build

102 North Lebanon St.

Lebanon, Ind.

Federal or State Highways  
County or Township Roads  
Railways

CLINTON COUNTY

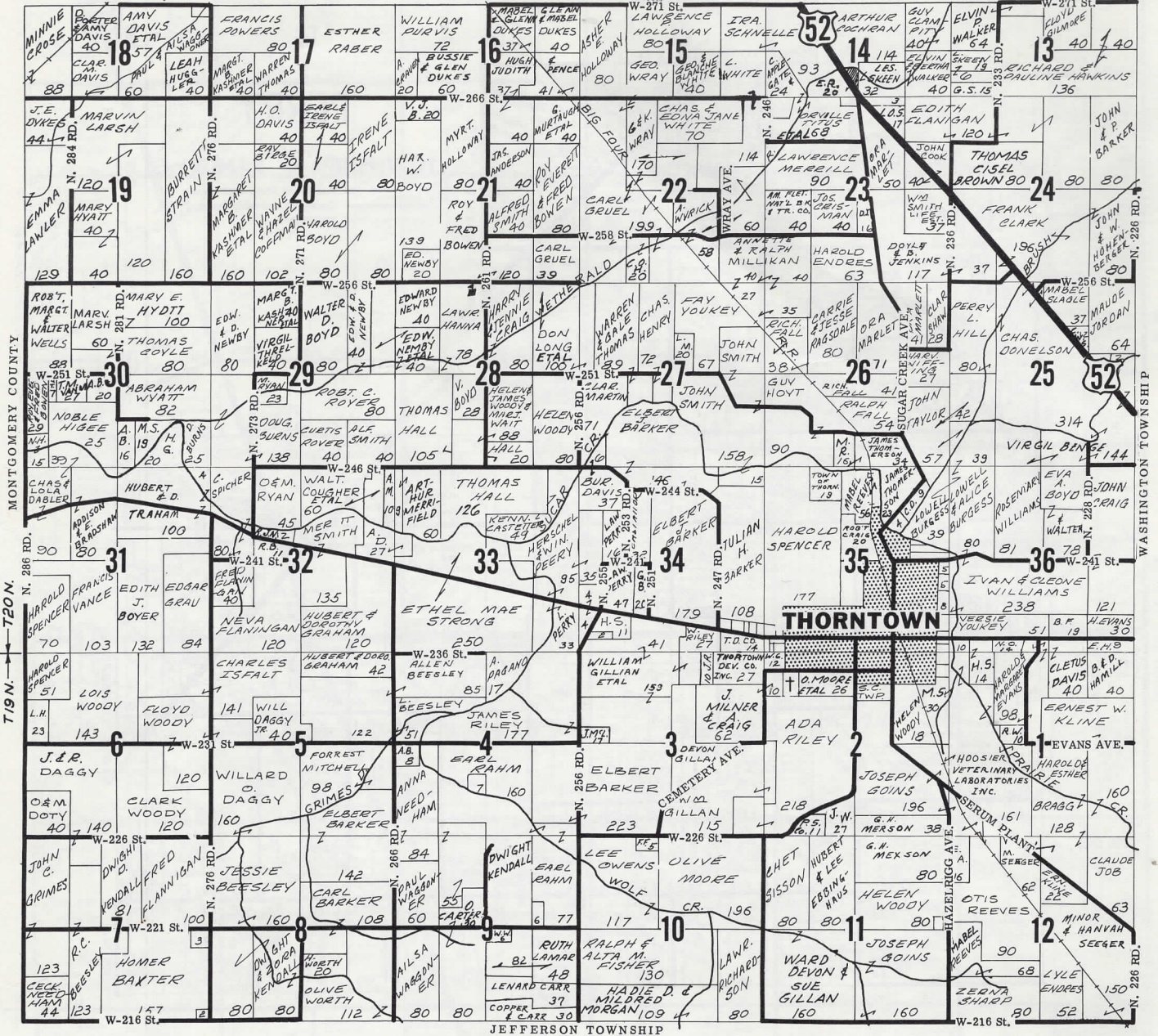

## Nay Insurance and Real Estate Agency

GENERAL INSURANCE - FARM, AUTO, LIABILITY, FIRE and LIFE

THORNTOWN

121 E. Main St. Telephone: 436-7222

INDIANA

TOWNSHIP 18-19 N RANGE 2-E

UNION

Federal or State Highways  
County or Township Roads  
Railways

MARION TOWNSHIP

W. 196 ST.

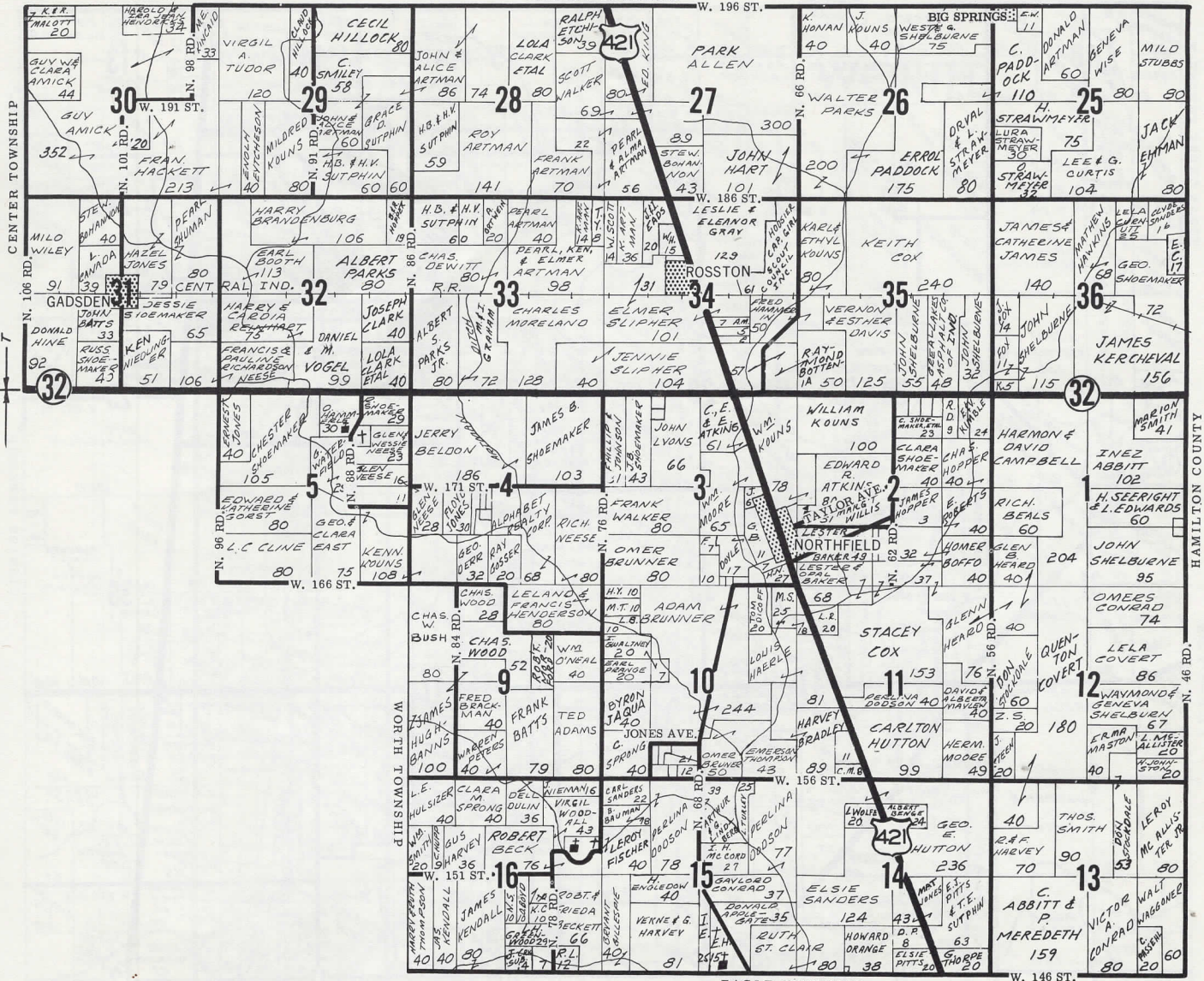

EAGLE TOWNSHIP

HAMILTON COUNTY

19-20  
TOWNSHIP N RANGE 1-W

WASHINGTON

Federal or State Highways  
County or Township Roads

CLINTON COUNTY

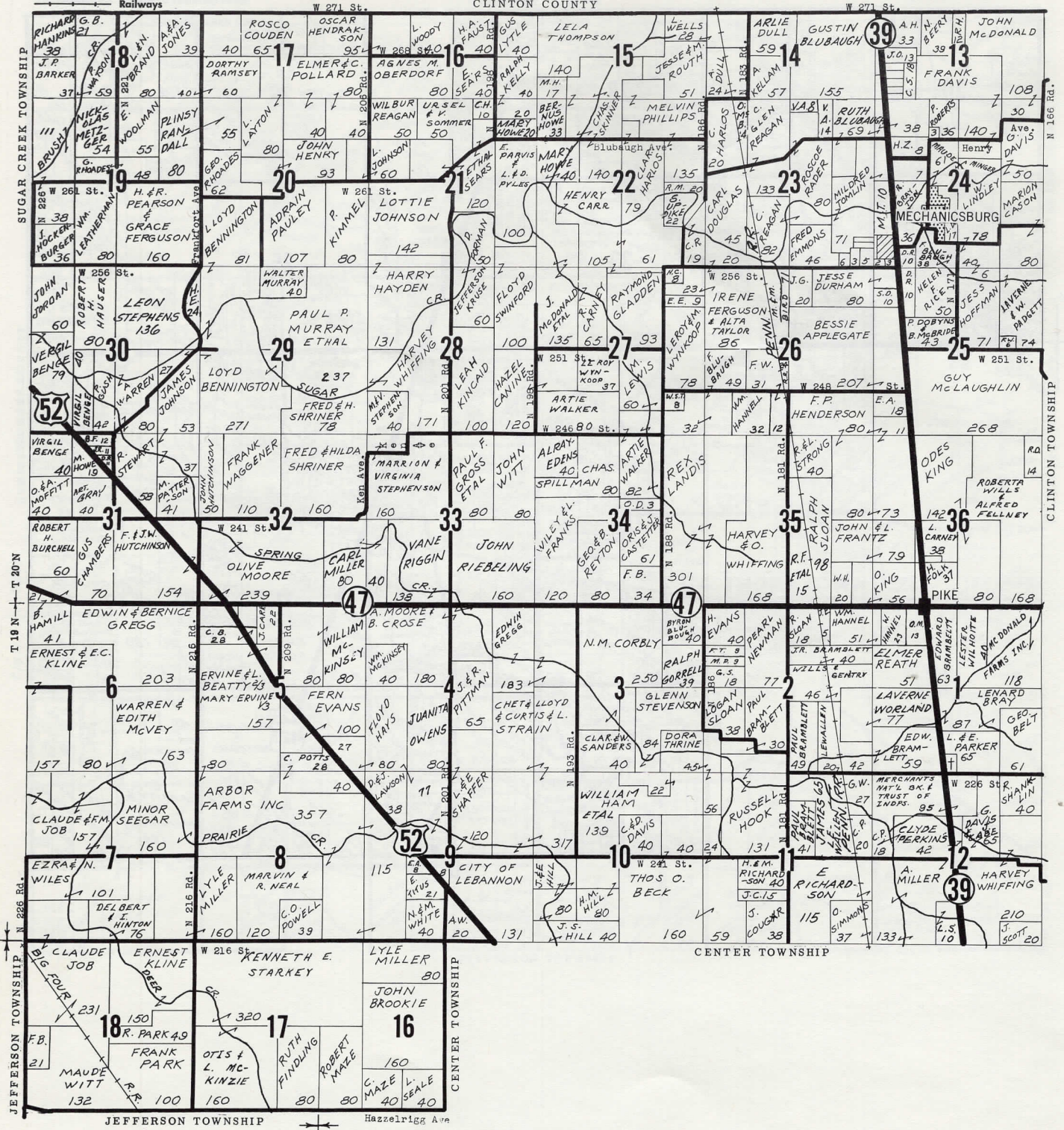



**TOWNSHIP 18-N RANGE 1-2-E**

Federal or State Highways  
 County or Township Roads  
 Railways

**WORTH**

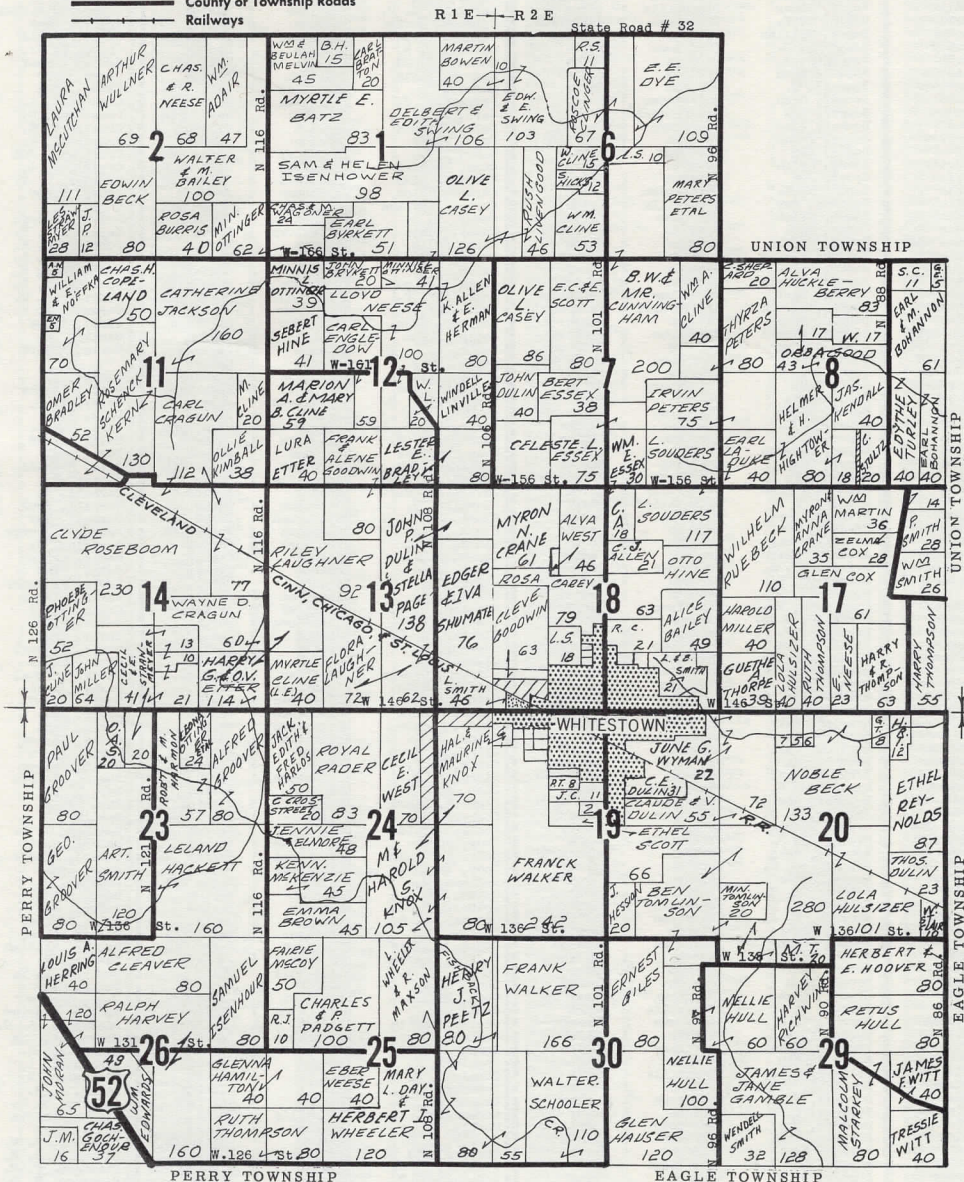

**JAMES B. METZGER EXCAVATING**

**WATERWAYS — CLEARING — STONE & FILL DIRT — EXPLOSIVES**

STATE ROAD 39 NORTH • TELEPHONE 2775

LEBANON, INDIANA











# ANALYSIS OF A SECTION OF LAND

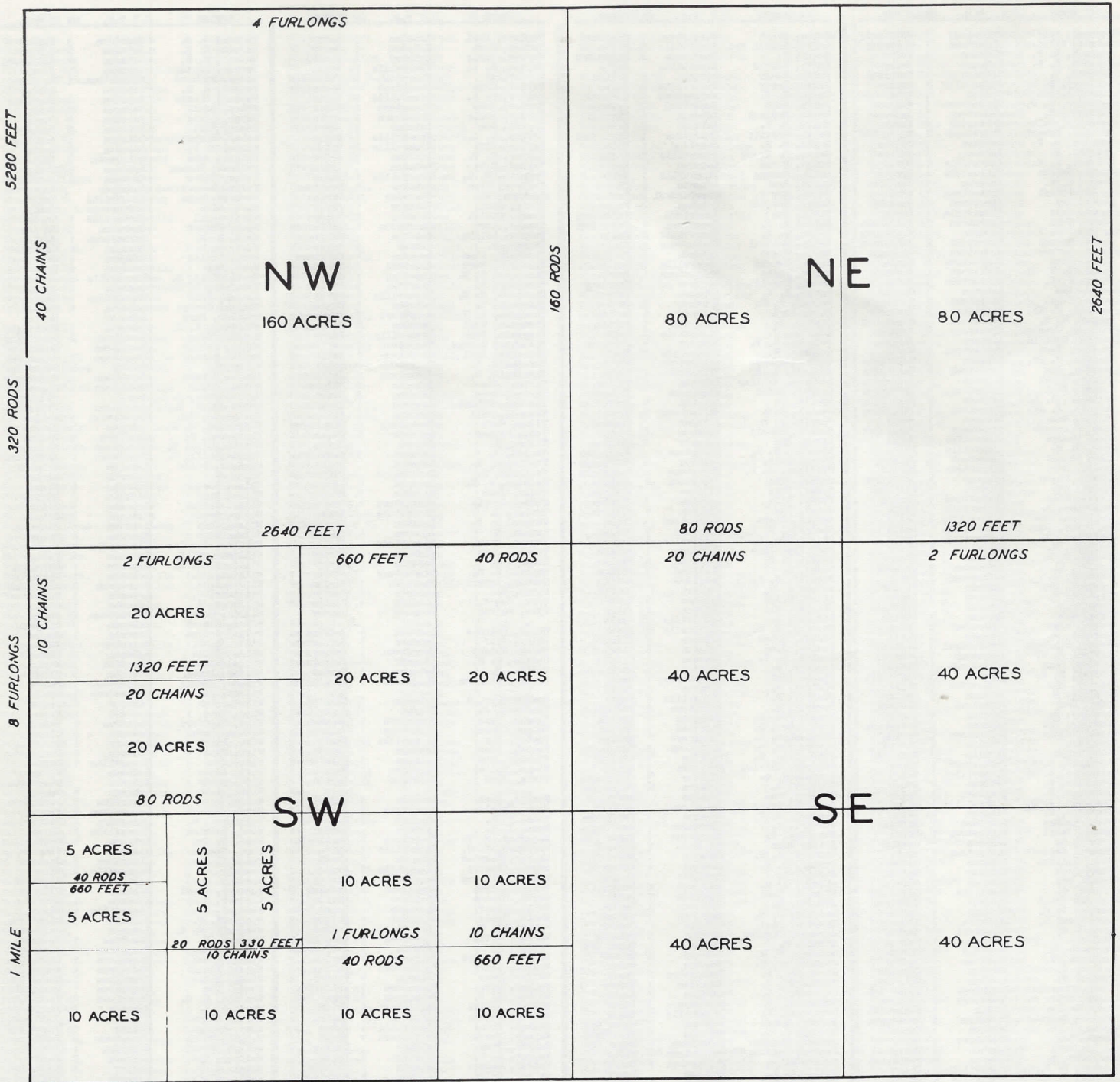

**LINEAR MEASURES**

	INCHES	FEET	RODS	LINKS	CHAINS	FURLONGS
1 LINK	7.92	0.66	0.04	1	0.01	0.001
1 FOOT	12	1	.0606061	1.515152	.0151515	.00151515
1 YARD	36	3	.181818	4.54545	.0454545	.00454545
1 ROD	198	16.5	1	25	0.25	0.025
1 CHAIN	792	66	4	100	1	.1
1 FURLONG	7920	660	40	1000	10	1
1 MILE	63.360	5,280	320	8,000	80	8

**SQUARE MEASURES**

	SQ. INCHES	SQ. FEET	SQ. YARDS	SQ. RODS	SQ. CHAINS
1 SQ. FOOT	144	1			
1 SQ. YARD		9	1		
1 SQ. ROD		272.25	30.25	1	
1 ACRE		43,560	4,840	160	10

640 ACRES = 1 SQ. MILE OR 1 SECTION  
 1 TOWNSHIP = 36 MILES SQ. OR 36 SQ. MILES OR 36 SECTIONS  
 1 ACRE IS ABOUT 208.75 FT. SQUARE OR CONTAINS 43,560 SQ. FEET OR ANY RECTANGULAR TRACT, THE PRODUCT OF THE LENGTH AND WIDTH OF WHICH TOTAL 160 SQ. RODS, WILL EQUAL 1 ACRE.



# STAHL-BAKER LUMBER CO.

BUILDING MATERIALS

WHITESTOWN

PHONE 769-3228

BOX 98

# HINE PHARMACY

VETERINARY

SUPPLIES

ANCHOR'S Serum  
& Vaccines

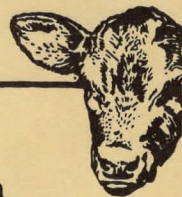

Whitestown, Ind.

PHONE 769-3247



WE DO THIS  
WORK WITH  
THE

*Electric Tel*

Best Way

# SMITH'S SANITARY SERVICE

SEPTIC TANKS CLEANED & INSTALLED

**Just Call**

**PL 8-4395**

415 Elm St. Sheridan, Ind.

*Stahl Bros.  
Lumber Company, Inc.*

PHONE PL 8 - 4216  
PAINT & BUILDING MATERIALS  
2 1/2 MILES SO. OF SHERIDAN

*Terhune Grain Corp.*

PHONE PL 8 - 4572

TERHUNE, INDIANA



# QUALITY INSURANCE, Inc.

R. J. PEPPLE

ALL KINDS OF INSURANCE

PHONES BUS. 676-5091 RES. 676-6111

JAMESTOWN,

INDIANA

# CITIZENS STATE BANK



"CONTINUOUSLY FOR OVER 77 YEARS"



THE OLDEST BANK IN BOONE COUNTY

JAMESTOWN, INDIANA

AREA CODE - 317

PHONE 676 - 5151

# BOONE COUNTY FARM BUREAU COOPERATIVE Ass'n, Inc.

LEBANON, INDIANA

CO-OP ELEVATOR LOCATED —  
402 S. MERIDIAN  
PHONE 2080 OR 2667

MAIN OFFICE —  
LUMBER & PETROLEUM DEPT.  
815 W. PEARL ST.  
PHONE 2080

- \* FEED & SEED
- \* FERTILIZER
- \* INSECTICIDES
- \* LIVESTOCK & POULTRY  
EQUIPMENT



- \* BUILDING SUPPLIES
- \* PETROLEUM PRODUCTS
- \* FERTILIZER
- \* HARDWARE SUPPLIES
- \* FENCE
- \* TIRES & BATTERIES

" ITS GOOD BUSINESS — BECAUSE ITS YOUR BUSINESS "

## BOONE COUNTY Farm Bureau, Inc.

AN ORGANIZED VOICE FOR BOONE COUNTY AGRICULTURE

Are You a Member? If Not, Join Today and Support the Largest, Most Powerful, Farm Organization

**IT'S GOOD BUSINESS TO BE IN FARM BUREAU**

A TIP FROM McBIP



# Farm Bureau Insurance

" ONE CONVENIENT  
MONTHLY PAYMENT  
WILL COVER ALL YOUR  
INSURANCE NEEDS  
FARM BUREAU "

PHONES: 8 & 2455

815 W. PEARL ST.

LEBANON, INDIANA



# value through innovation

UNDATED PLAT BOOK

WALTER HARPEL AD ON PAGE 1  
INDICATES ITS AFTER 1956

BOONE FARM MUTUAL AD ON PAGE 4  
INDICATES ITS AT LEAST 1961  
EST 1896 + OVER 65 YEARS IN BUSINESS

SHELBY CHEVROLET AD ON PAGE 8  
INDICATES THE CURRENT YEAR IS 1964



Boehringer  
Ingelheim

BI0112005